

PDDR

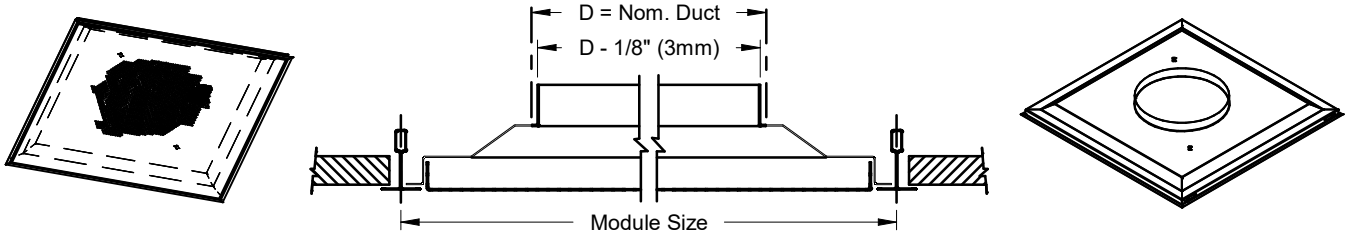

CONSTRUCTION:

- Perforated face - $3/16$ " (5mm) holes, 51% free area:
 - F-ST - Steel face
 - F-AL - Aluminum face
- Frame and backpan - steel construction
- Steel spring latches

FINISH:

- Perforated face
 - B12 - Standard White
- Backpan and outer frame
 - B12 - Standard White
 - BBP - Black (available with frames 3, 15 and 17B only)

Optional finishes available:

- Optional colors
- Custom colors
- Armstrong coordinated finishes

See finishes brochure for additional information. Contact your PRICE representative for leadtimes and pricing.

NOTES:

- Face panel is removable
- Dampers and light shield ship loose
- Factory tolerance $\pm 1/32$ " (1mm)

FRAME STYLES:

- 1 - Surface Mount

Ceiling Opening = Module Size

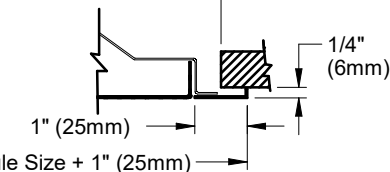

Module Size + 1" (25mm)

- 2 - Snap-In

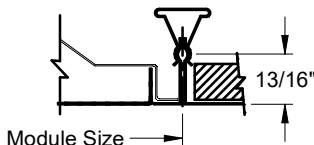

Module Size

- 3 - $15/16$ " T-Bar Lay-In

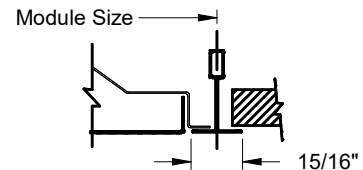

Module Size

- 4 - Spline

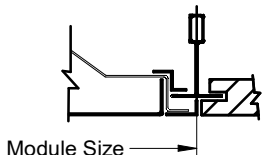

Module Size

- 15 - $15/16$ " Tegral T-bar

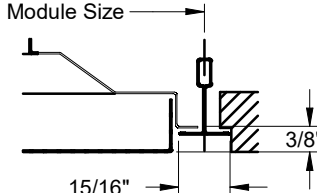

15/16"

- 17B - $9/16$ " Bolt Slot T-Bar only

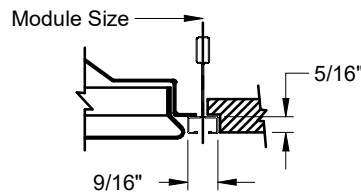

9/16"

Note:
Style 17B available in 12"x12", 24"x12" and 24"x24" ceiling modules only

OPTIONAL STEEL DAMPERS:

- For round ducts:
 - VCR7 - Radial opposed blade damper
 - VCR8 - Full flow damper with duct mounting ring (n/a for 16", 18")
 - VCR8E - Full flow damper, diffuser neck mounted (n/a for 16", 18")
 - VCR9 - Radial damper (n/a for 15", 16", 18")
- For square / rectangular ducts:
 - VCS3 - Opposed blade damper

OPTIONS:

- Insulation:
 - R6 - Moulded backpan insulation (available with frame A only)
 - AFI - Foil backed fiberglass insulation (available with frame B only)
- Hangers:
 - Integral hanger loops (standard)
 - EHT - Extended hanger tabs
- BN - Beaded round inlet neck with extended $2\frac{1}{2}$ " (64mm) length
- LS - Light shield - steel construction, black finish (square / rectangular inlets only, not available with damper, not available on 46" x 22" inlet size (1168mm x 559mm)

6" (152mm)

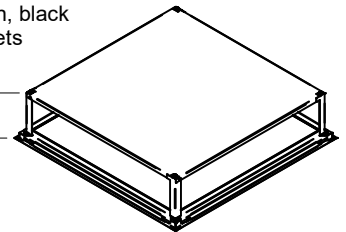

ALL METRIC DIMENSIONS () ARE SOFT CONVERTED. IMPERIAL DIMENSIONS ARE CONVERTED TO METRIC AND ROUNDED TO THE NEAREST MILLIMETER.

PROJECT:		<p>PDDR PERFORATED RETURN AIR DIFFUSER</p>
ENGINEER:		
CUSTOMER:		
SUBMITTAL DATE:	SPEC. SYMBOL:	
		<p>270593</p> <p>2023-01-20</p>

PDDR

Module Size	Round Duct								Square / Rectangular Duct													
	6" (152mm)	8" (203mm)	10" (254mm)	12" (305mm)	14" (356mm)	15" (381mm)	16" (406mm)	18" (457mm)	6" x 6" (152mm x 152mm)	8" x 8" (203mm x 203mm)	10" x 10" (254mm x 254mm)	12" x 12" (305mm x 305mm)	14" x 14" (356mm x 356mm)	15" x 15" (381mm x 381mm)	16" x 16" (406mm x 406mm)	18" x 18" (457mm x 457mm)	20" x 20" (508mm x 508mm)	22" x 22" (559mm x 559mm)	18" x 6" (457mm x 152mm)	22" x 10" (559mm x 254mm)	46" x 22" (1168mm x 559mm)	
12" x 12"	B	E	E					B	D	C												
24" x 12"	B	E	E					B	E	E									B	C		
16" x 16"	B	B	B	E	E			B	B	B	D	C										
18" x 18"	B	B	B	B	E			B	B	B	B	D	E	C								
20" x 20"	B	B	B	B	B			B	B	B	B	B	E	D	C							
24" x 24"	A	A	A	A	A	A	A	A	A	A	A	A	A	A	A	D	C					
48" x 12"	B	E	E					B	E	E									B			
48" x 24"	B	B	B	B	B	B	B	B	B	B	B	B	B	B	B	E	E					C
300mm x 300mm	B	E	E					B	D	C												
600mm x 300mm	B	E	E					B	E	E									E	C		
400mm x 400mm	B	B	B	E	E			B	B	E	D	C										
500mm x 500mm	B	B	B	B	B			B	B	B	B	E	E	D	C							
600mm x 600mm	B	B	B	B	B	B	B	B	B	B	B	B	B	B	E	D	C					
1200mm x 300mm	B	E	E					B	E	E									B			
1200mm x 600mm	B	B	B	B	B	B	B	B	B	B	B	B	B	B	E	E	E					C

Letters indicate frame profile supplied for each module / inlet combination (see section details).
Module / inlet size combinations with a blank are not available.

FRAME PROFILES:

A

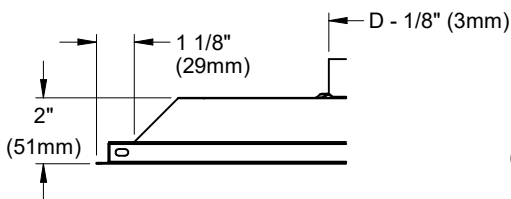

B

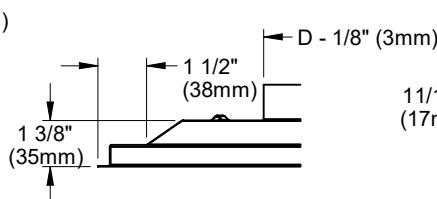

C

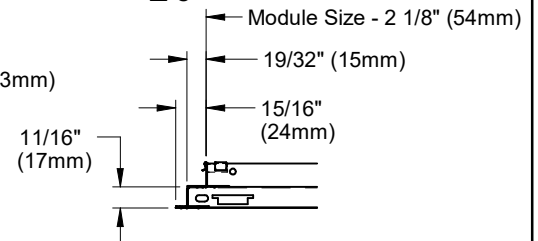

D

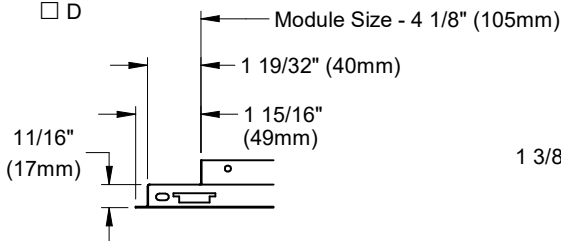

E

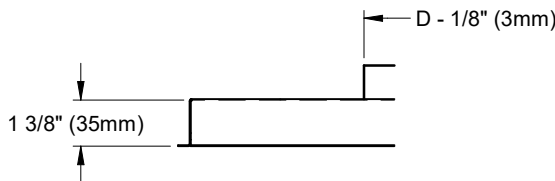

Scan for link to additional product information

ALL METRIC DIMENSIONS () ARE SOFT CONVERTED. IMPERIAL DIMENSIONS ARE CONVERTED TO METRIC AND ROUNDED TO THE NEAREST MILLIMETER.

PROJECT:

ENGINEER:

CUSTOMER:

SUBMITTAL DATE:

SPEC. SYMBOL:

PRICE	
<i>MJ</i>	PDDR
270593	PERFORATED RETURN AIR DIFFUSER
2023-01-20	